













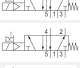

5/2-directional valve, Series CERAM™, size 4

- 5/2
- $Q_n = 7.62 \text{ Cv}$
- Pilot valve width : 30 mm
- Plate connection
- Electrical connection : Plug, EN 175301-803, form A
- Can be assembled into blocks
- Manual override : with detent, without detent
- single solenoid
- with air spring return
- Pilot : Internal, External

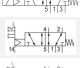

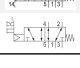
Activation	Electrically
Sealing principle	Ceramic
Blocking principle	Single base plate principle
Standards	ISO 5599-1, ISO 4
Working pressure min./max.	See table below
Control pressure min./max.	See table below
Ambient temperature min./max.	5 ... 150 °F
Medium temperature min./max.	5 ... 150 °F
Medium	Compressed air
Nominal flow Q_n	7.62 Cv
Compressed air connection	according to ISO 5599-1
Protection class according to NEMA	NEMA 4
Weight	See table below

Technical data

Part No.		MO	Compressed air connection	Operational voltage
			Pilot Exhaust	DC
R432006325			Base plate ISO 5599-1	12 V
R432006326			Base plate ISO 5599-1	24 V
R432030177			Base plate ISO 5599-1	-
R432006321			Base plate ISO 5599-1	-
R432006323			Base plate ISO 5599-1	-
R432002464			Base plate ISO 5599-1	-
R432002467			Base plate ISO 5599-1	-

Part No.	Operational voltage	Operational voltage	Voltage tolerance
	AC 50 Hz	AC 60 Hz	DC
R432006325	-	-	-10% / +10%
R432006326	-	-	-10% / +10%
R432030177	24 V	24 V	-
R432006321	110 V	120 V	-
R432006323	220 V	240 V	-
R432002464	-	-	-
R432002467	-	-	-

Part No.	Voltage tolerance	Voltage tolerance	Power consumption	Holding power
	AC 50 Hz	AC 60 Hz	DC	AC 50 Hz
R432006325	-	-	2.7 W	-
R432006326	-	-	2.7 W	-
R432030177	-10% / +10%	-10% / +10%	-	3.7 VA
R432006321	-10% / +10%	-10% / +10%	-	3.7 VA
R432006323	-10% / +10%	-10% / +10%	-	3.7 VA
R432002464	-	-	-	-
R432002467	-	-	-	-

Part No.	Holding power	Switch-on power	Switch-on power	Pilot	Working pressure min./max.
	AC 60 Hz	AC 50 Hz	AC 60 Hz		
R432006325	-	-	-	Internal	0 ... 145 psi
R432006326	-	-	-	Internal	0 ... 145 psi
R432030177	3.7 VA	6.4 VA	6.4 VA	Internal	0 ... 145 psi
R432006321	3.7 VA	6.4 VA	6.4 VA	Internal	0 ... 145 psi
R432006323	3.7 VA	6.7 VA	6.7 VA	Internal	0 ... 145 psi
R432002464	-	-	-	External	0 ... 149 psi
R432002467	-	-	-	Internal	0 ... 145 psi

Part No.	Control pressure min./max.	With valve plug connector
R432006325	37 ... 149 psi	Without valve plug connector
R432006326	37 ... 149 psi	Without valve plug connector
R432030177	37 ... 149 psi	Without valve plug connector
R432006321	37 ... 149 psi	Without valve plug connector
R432006323	37 ... 149 psi	Without valve plug connector

Part No.	Control pressure min./max.	With valve plug connector
R432002464	-11 ... 149 psi	Without valve plug connector
R432002467	37 ... 149 psi	Without valve plug connector

Part No.	basic valve with electrical connector	Mounting screw	Weight
R432006325	-	M8 with hexagon socket	5.25 lbs
R432006326	-	M8 with hexagon socket	5.25 lbs
R432030177	-	M8 with hexagon socket	5.25 lbs
R432006321	-	M8 with hexagon socket	5.25 lbs
R432006323	-	M8 with hexagon socket	5.25 lbs
R432002464	Basic valve without coil	M5 with hexagon socket	4.61 lbs
R432002467	Basic valve without coil	M8 with hexagon socket	4.61 lbs

Nominal flow Qn at 87 psi and Δp = 14.5 psi

MO = Manual override

Technical information

The min. control pressure must be adhered to, since otherwise faulty switching and valve failure may result!
 The pressure dew point must be at least 27 °F under ambient and medium temperature and may not exceed 5.4 °F .
 The oil content of compressed air must remain constant during the life cycle.
 Use only the approved oils from AVENTICS. Further information can be found in the "Technical information" document (available in the MediaCentre).

Technical information

Material	
Housing	Die-cast aluminum, painted gray

Dimensions

Dimensions in inches

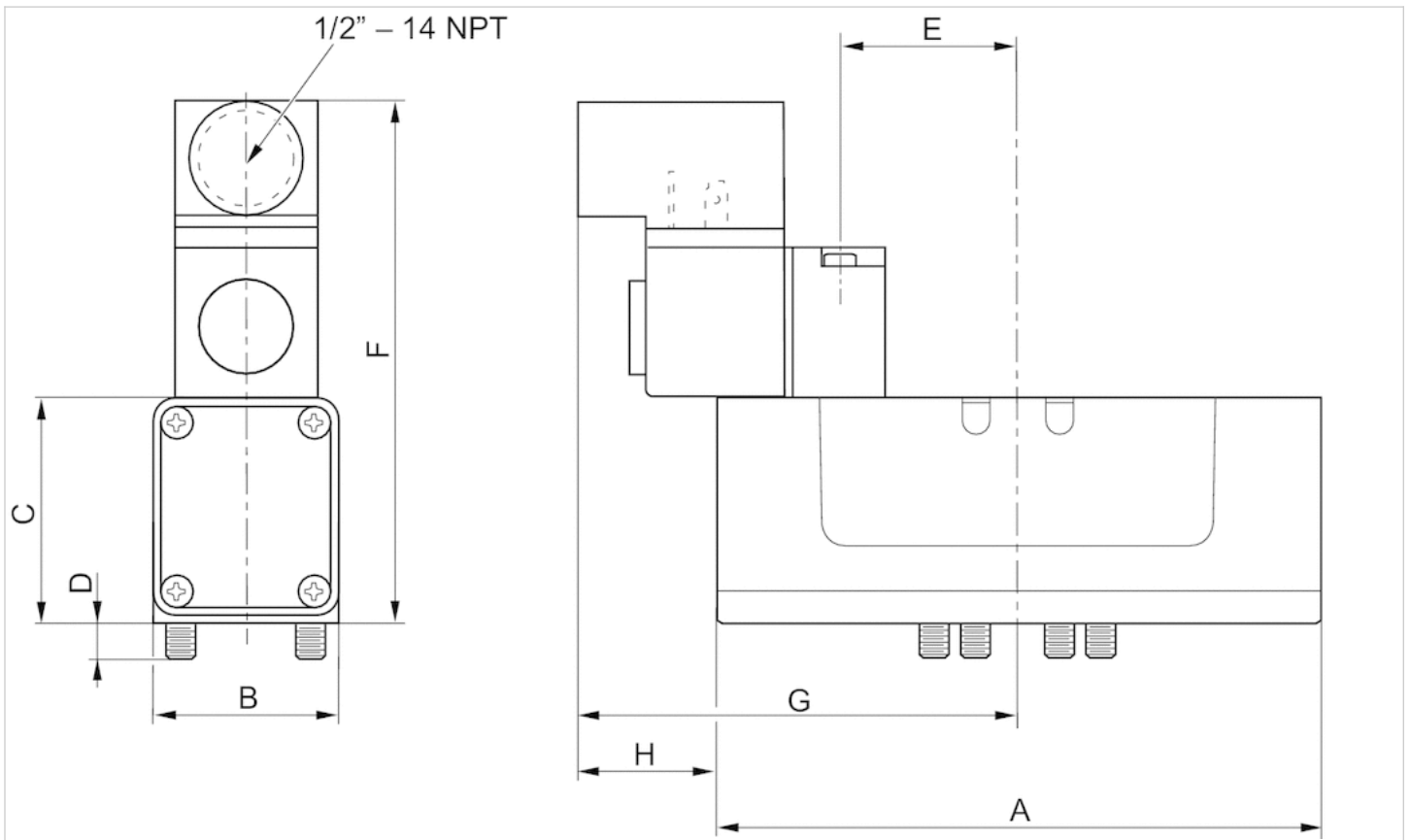

Dimensions in inches

Part No.	A	B	C	D	E	F	G	H
R432006325	8.62	3.09	2.89	0.41	1.62	5.23	6.65	0.68
R432006326	8.62	3.09	2.89	0.41	1.62	5.23	6.65	0.68
R432030177	8.62	3.09	2.89	0.41	1.62	5.23	6.65	0.68
R432006321	8.62	3.09	2.89	0.41	1.62	5.23	6.65	0.68
R432006323	8.62	3.09	2.89	0.41	1.62	5.23	6.65	0.68
-	-	-	-	-	-	-	-	-
R432002467	8.62	3.09	2.89	0.41	1.62	5.23	6.65	0.68

5/2-directional valve, Series CERAM™, size 4

- 5/2
- Qn = 7.62 Cv
- Pilot valve width : 30 mm CNOMO
- Plate connection
- Electrical connection : Plug, EN 175301-803, form A
- Can be assembled into blocks
- Manual override : with detent, without detent
- single solenoid
- with air spring return
- Pilot : Internal, External



Activation	Electrically
Sealing principle	Ceramic
Blocking principle	Single base plate principle
Standards	ISO 5599-1, ISO 4
Working pressure min./max.	0 ... 149 psi
Control pressure min./max.	37 ... 149 psi
Ambient temperature min./max.	5 ... 150 °F
Medium temperature min./max.	5 ... 150 °F
Medium	Compressed air
Nominal flow Qn	7.62 Cv
Compressed air connection	according to ISO 5599-1
Protection class according to NEMA	NEMA 4
mounting screws	M8 with hexagon socket
Weight	See table below

Technical data

Part No.	MO	Compressed air connection		Operational voltage
		Pilot Exhaust		DC
R432030378		Base plate ISO 5599-1		12 V
R432006327		Base plate ISO 5599-1		24 V
R432030352		Base plate ISO 5599-1		-
R432006322		Base plate ISO 5599-1		-
R432006324		Base plate ISO 5599-1		-
R432002465		Base plate ISO 5599-1		-
R432002468		Base plate ISO 5599-1		-

Part No.	Operational voltage		Voltage tolerance
	AC 50 Hz	AC 60 Hz	DC
R432030378	-	-	-10% / +10%
R432006327	-	-	-10% / +10%
R432030352	24 V	24 V	-
R432006322	110 V	120 V	-
R432006324	220 V	240 V	-
R432002465	-	-	-

Part No.	Operational voltage	Operational voltage	Voltage tolerance
	AC 50 Hz	AC 60 Hz	DC
R432002468	-	-	-

Part No.	Voltage tolerance	Voltage tolerance	Power consumption	Holding power
	AC 50 Hz	AC 60 Hz	DC	AC 50 Hz
R432030378	-	-	2.7 W	-
R432006327	-	-	2.7 W	-
R432030352	-10% / +10%	-10% / +10%	-	3.7 VA
R432006322	-10% / +10%	-10% / +10%	-	3.7 VA
R432006324	-10% / +10%	-10% / +10%	-	3.7 VA
R432002465	-	-	-	-
R432002468	-	-	-	-

Part No.	Holding power	Switch-on power	Switch-on power	Pilot
	AC 60 Hz	AC 50 Hz	AC 60 Hz	
R432030378	-	-	-	Internal
R432006327	-	-	-	Internal
R432030352	3.7 VA	6.4 VA	6.4 VA	Internal
R432006322	3.7 VA	6.4 VA	6.4 VA	Internal
R432006324	3.7 VA	6.4 VA	6.4 VA	Internal
R432002465	-	-	-	External
R432002468	-	-	-	Internal

Part No.	With valve plug connector	basic valve with electrical connector	Weight
R432030378	Without valve plug connector	-	5.4 lbs
R432006327	Without valve plug connector	-	5.4 lbs
R432030352	Without valve plug connector	-	5.4 lbs
R432006322	Without valve plug connector	-	5.41 lbs
R432006324	Without valve plug connector	-	5.41 lbs
R432002465	Without valve plug connector	Basic valve without coil	4.61 lbs
R432002468	Without valve plug connector	Basic valve without coil	4.61 lbs

Nominal flow Qn at 87 psi and $\Delta p = 14.5$ psi

MO = Manual override

Technical information

The min. control pressure must be adhered to, since otherwise faulty switching and valve failure may result!

The pressure dew point must be at least 27 °F under ambient and medium temperature and may not exceed 5.4 °F .

The oil content of compressed air must remain constant during the life cycle.

Use only the approved oils from AVENTICS. Further information can be found in the "Technical information" document (available in the MediaCentre).

Technical information

Material	
Housing	Die cast zinc, painted gray, Die-cast aluminum, painted gray

Dimensions

Dimensions in inches

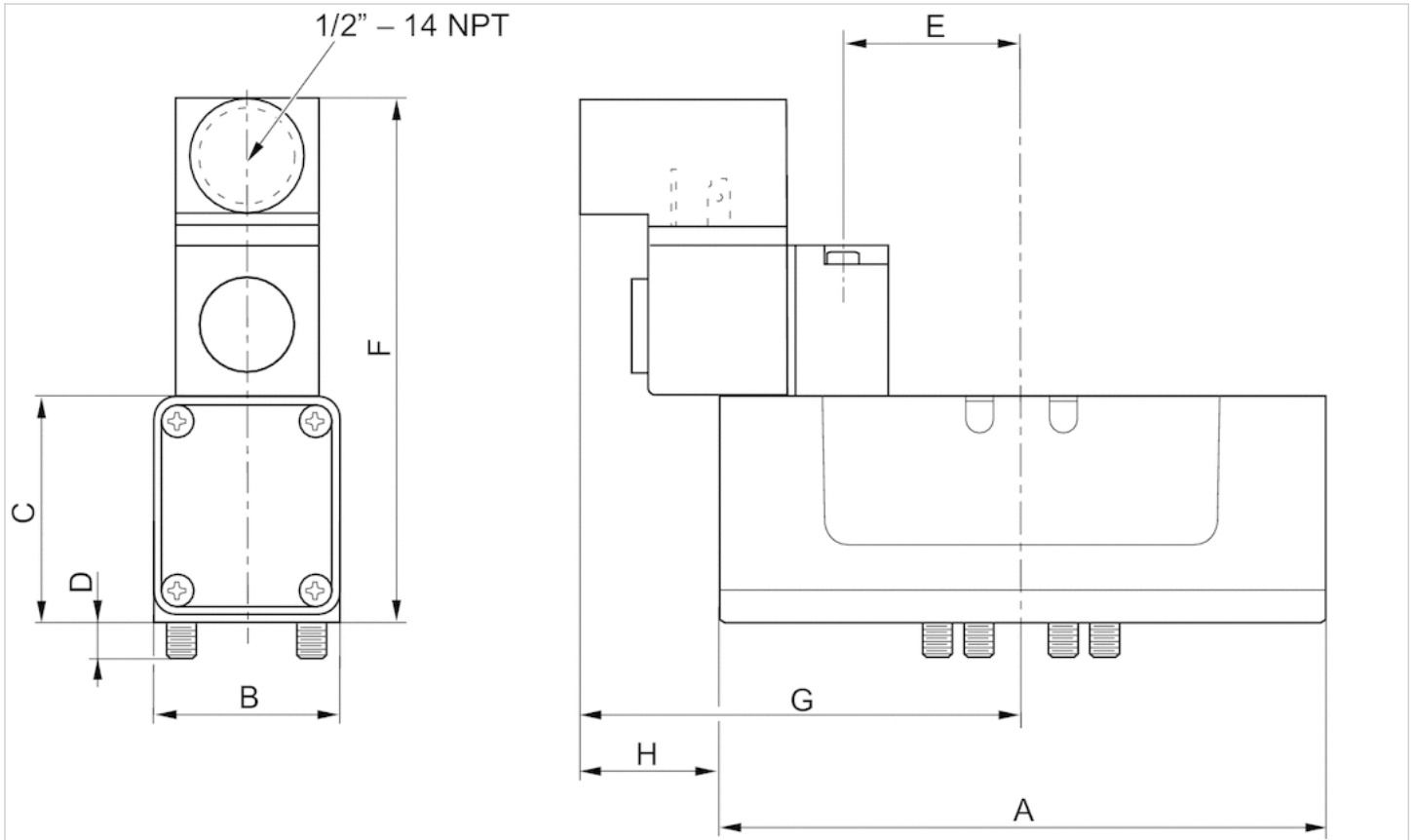

Dimensions in inches

Part No.	A	B	C	D	E	F	G	H
R432030378	8.62	3.09	2.89	0.41	1.62	5.23	6.65	0.68
R432006327	8.62	3.09	2.89	0.41	1.62	5.23	6.65	0.68
R432030352	8.62	3.09	2.89	0.41	1.62	5.23	6.65	0.68
R432006322	8.62	3.09	2.89	0.41	1.62	5.23	6.65	0.68
R432006324	8.62	3.09	2.89	0.41	1.62	5.23	6.65	0.68
-	-	-	-	-	-	-	-	-
R432002468	8.62	3.09	2.89	0.41	1.62	5.23	6.65	0.68





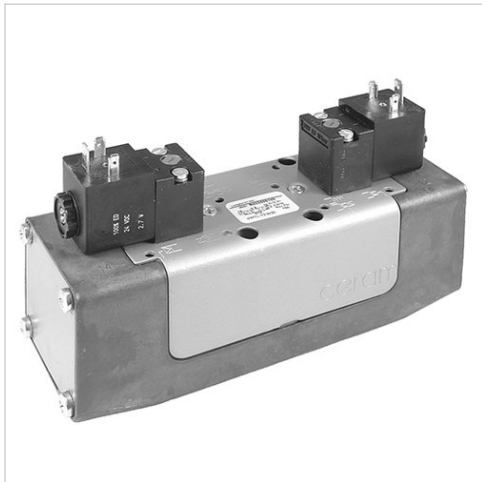

5/2-directional valve, Series CERAM™, size 4

- 5/2
- $Q_n = 7.62 \text{ Cv}$
- Pilot valve width : 30 mm CNOMO
- Plate connection
- Electrical connection : Plug, EN 175301-803, form A
- Can be assembled into blocks
- Manual override : with detent, without detent
- Double solenoid, single solenoid
- Pilot : Internal, External

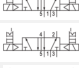
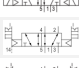
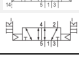

Activation	Electrically
Sealing principle	Ceramic
Blocking principle	Single base plate principle
Standards	ISO 5599-1, ISO 4
Working pressure min./max.	0 ... 149 psi
Control pressure min./max.	See table below
Ambient temperature min./max.	5 ... 150 °F
Medium temperature min./max.	5 ... 150 °F
Medium	Compressed air
Nominal flow Q_n	7.62 Cv
Compressed air connection	according to ISO 5599-1
Protection class according to NEMA	NEMA 4
Weight	See table below

Technical data

Part No.		MO	Compressed air connection		Operational voltage
			Pilot Exhaust		DC
R432030353		TR-TR-TR-TR-TR-TR-TR	Base plate ISO 5599-1		12 V
R432006341			Base plate ISO 5599-1		24 V
R432030178			Base plate ISO 5599-1		-
R432006339			Base plate ISO 5599-1		-
R432006340			Base plate ISO 5599-1		-
R432002466			Base plate ISO 5599-1		-
R432002469			Base plate ISO 5599-1		-

Part No.	Operational voltage		Voltage tolerance
	AC 50 Hz	AC 60 Hz	DC
R432030353	-	-	-10% / +10%
R432006341	-	-	-10% / +10%
R432030178	24 V	24 V	-
R432006339	110 V	120 V	-
R432006340	220 V	240 V	-
R432002466	-	-	-
R432002469	-	-	-

Part No.	Voltage tolerance	Voltage tolerance	Power consumption	Holding power
	AC 50 Hz	AC 60 Hz	DC	AC 50 Hz
R432030353	-	-	2.7 W	-
R432006341	-	-	2.7 W	-
R432030178	-10% / +10%	-10% / +10%	-	3.7 VA
R432006339	-10% / +10%	-10% / +10%	-	3.7 VA
R432006340	-10% / +10%	-10% / +10%	-	3.7 VA
R432002466	-	-	-	-
R432002469	-	-	-	-

Part No.	Holding power	Switch-on power	Switch-on power	Pilot	Control pressure min./max.
	AC 60 Hz	AC 50 Hz	AC 60 Hz		
R432030353	-	-	-	Internal	29 ... 149 psi
R432006341	-	-	-	Internal	29 ... 149 psi
R432030178	3.7 VA	6.4 VA	6.4 VA	Internal	29 ... 149 psi
R432006339	3.7 VA	6.4 VA	6.4 VA	Internal	29 ... 149 psi
R432006340	3.7 VA	6.4 VA	6.4 VA	Internal	29 ... 149 psi
R432002466	-	-	-	External	37 ... 149 psi
R432002469	-	-	-	Internal	29 ... 149 psi

Part No.	With valve plug connector	basic valve with electrical connector
R432030353	Without valve plug connector	-
R432006341	Without valve plug connector	-
R432030178	Without valve plug connector	-
R432006339	Without valve plug connector	-
R432006340	Without valve plug connector	-

Part No.	With valve plug connector	basic valve with electrical connector
R432002466	Without valve plug connector	Basic valve without coil
R432002469	Without valve plug connector	Basic valve without coil

Part No.	Mounting screw	Weight
R432030353	M8 with hexagon socket	5.42 lbs
R432006341	M8 with hexagon socket	5.42 lbs
R432030178	M8 with hexagon socket	5.42 lbs
R432006339	M8 with hexagon socket	5.42 lbs
R432006340	M8 with hexagon socket	5.42 lbs
R432002466	M5 with hexagon socket	5.11 lbs
R432002469	M8 with hexagon socket	5.11 lbs

Nominal flow Qn at 87 psi and Δp = 14.5 psi

MO = Manual override

Technical information

The min. control pressure must be adhered to, since otherwise faulty switching and valve failure may result!
 The pressure dew point must be at least 27 °F under ambient and medium temperature and may not exceed 5.4 °F .
 The oil content of compressed air must remain constant during the life cycle.
 Use only the approved oils from AVENTICS. Further information can be found in the “Technical information” document (available in the MediaCentre).

Technical information

Material	
Housing	Die-cast aluminum, painted gray

Dimensions

Dimensions in inches

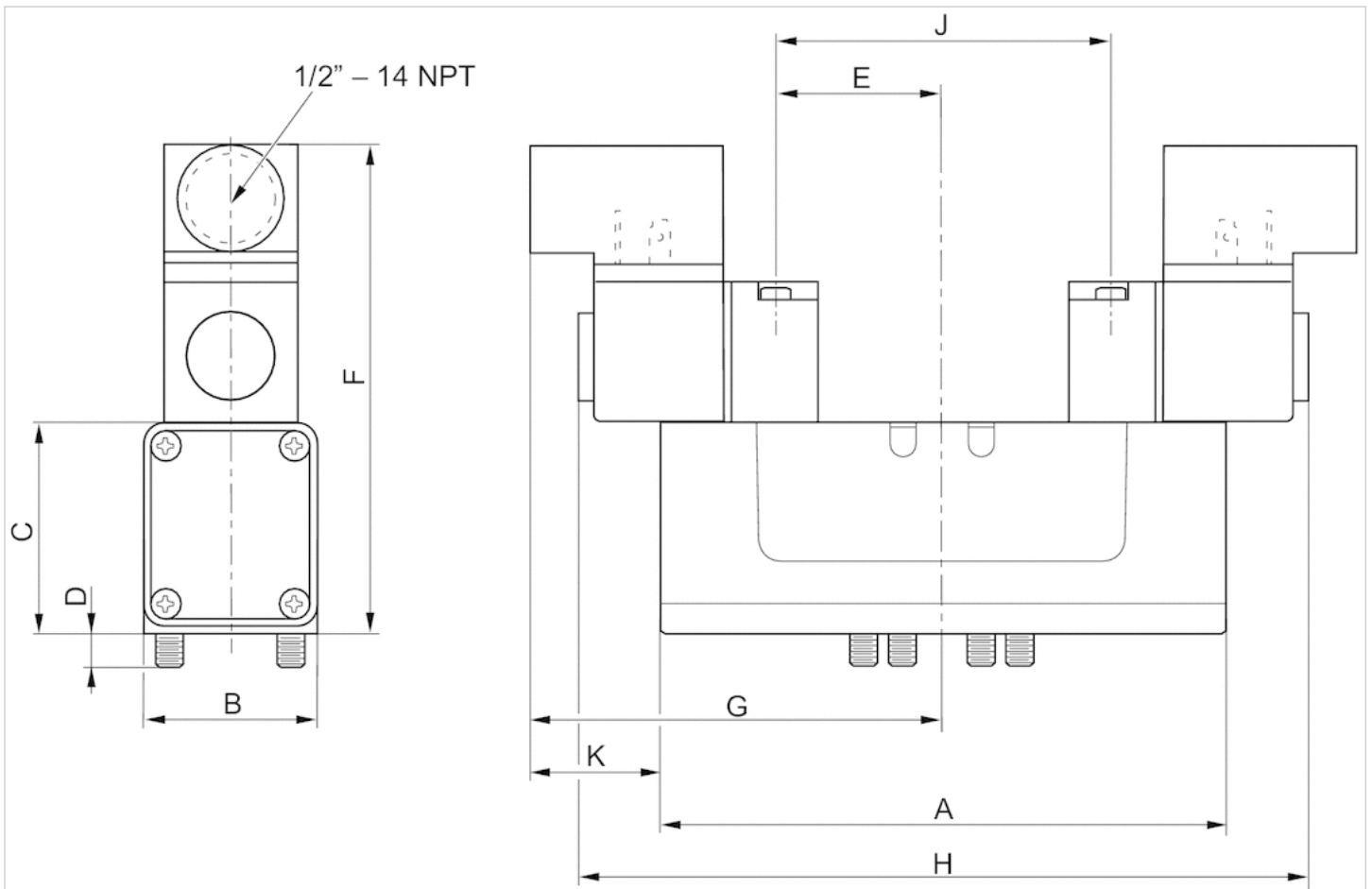

Dimensions in inches

Part No.	A	B	C	D	E	F	G	H	J	K
R432030353	8.62	3.09	2.89	0.41	1.62	5.32	6.65	13.31	3.25	0.68
R432006341	8.62	3.09	2.89	0.41	1.62	5.32	6.65	13.31	3.25	0.68
R432030178	8.62	3.09	2.89	0.41	1.62	5.32	6.65	13.31	3.25	0.68
R432006339	8.62	3.09	2.89	0.41	1.62	5.32	6.65	13.31	3.25	0.68
R432006340	8.62	3.09	2.89	0.41	1.62	5.32	6.65	13.31	3.25	0.68
-	-	-	-	-	-	-	-	-	-	-
R432002469	8.62	3.09	2.89	0.41	1.62	5.32	6.65	13.31	3.25	0.68

5/3-directional valve, Series CERAM™, size 4

- 5/3
- Qn = 7.62 Cv
- Pilot valve width : 30 mm CNOMO
- closed center
- Plate connection
- Electrical connection : Plug, EN 175301-803, form A
- Can be assembled into blocks
- Manual override : with detent, without detent
- Double solenoid, single solenoid
- Pilot : Internal, External

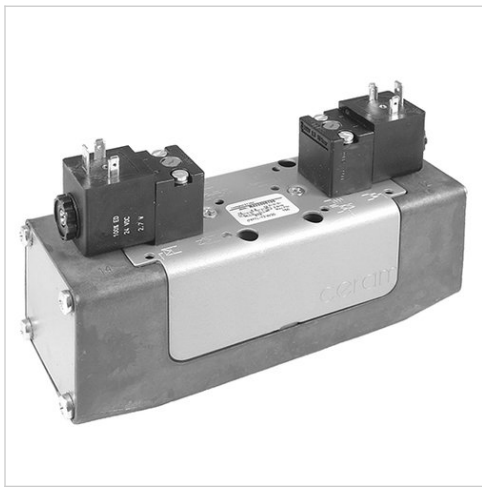

Activation	Electrically
Blocking principle	Single base plate principle
Standards	ISO 5599-1, ISO 4
Working pressure min./max.	0 ... 149 psi
Control pressure min./max.	See table below
Ambient temperature min./max.	5 ... 150 °F
Medium temperature min./max.	5 ... 150 °F
Medium	Compressed air
Nominal flow Qn	7.62 Cv
Compressed air connection	according to ISO 5599-1
Protection class according to NEMA	NEMA 4
mounting screws	M8 with hexagon socket
Weight	See table below

Technical data

Part No.	MO	Compressed air connection	Operational voltage
R432006292	TR-TR-TR-TR-TR-TR	Base plate ISO 5599-1	12 V
R432006293		Base plate ISO 5599-1	24 V
R432030338		Base plate ISO 5599-1	-
R432006290		Base plate ISO 5599-1	-
R432006291		Base plate ISO 5599-1	-
R432002461		Base plate ISO 5599-1	-
R432002463		Base plate ISO 5599-1	-

Part No.	Operational voltage		Voltage tolerance
	AC 50 Hz	AC 60 Hz	DC
R432006292	-	-	-10% / +10%
R432006293	-	-	-10% / +10%
R432030338	24 V	24 V	-
R432006290	110 V	120 V	-
R432006291	220 V	240 V	-
R432002461	-	-	-
R432002463	-	-	-

Part No.	Voltage tolerance	Voltage tolerance	Power consumption	Holding power
	AC 50 Hz	AC 60 Hz	DC	AC 50 Hz
R432006292	-	-	2.7 W	-
R432006293	-	-	2.7 W	-
R432030338	-10% / +10%	-10% / +10%	-	3.7 VA
R432006290	-10% / +10%	-10% / +10%	-	3.7 VA
R432006291	-10% / +10%	-10% / +10%	-	3.7 VA
R432002461	-	-	-	-
R432002463	-	-	-	-

Part No.	Holding power	Switch-on power	Switch-on power	Pilot	Control pressure min./max.
	AC 60 Hz	AC 50 Hz	AC 60 Hz		
R432006292	-	-	-	Internal	37 ... 149 psi
R432006293	-	-	-	Internal	37 ... 149 psi
R432030338	3.7 VA	6.4 VA	6.4 VA	Internal	37 ... 149 psi
R432006290	3.7 VA	6.4 VA	6.4 VA	Internal	37 ... 149 psi
R432006291	3.7 VA	6.4 VA	6.4 VA	Internal	37 ... 149 psi
R432002461	-	-	-	External	-11 ... 149 psi
R432002463	-	-	-	Internal	37 ... 149 psi

Part No.	With valve plug connector	basic valve with electrical connector	Weight
R432006292	Without valve plug connector	-	5.6 lbs
R432006293	Without valve plug connector	-	5.4 lbs
R432030338	Without valve plug connector	-	-
R432006290	Without valve plug connector	-	5.71 lbs
R432006291	Without valve plug connector	-	5.71 lbs
R432002461	Without valve plug connector	Basic valve without coil	5.32 lbs
R432002463	Without valve plug connector	Basic valve without coil	5.32 lbs

Nominal flow Qn at 87 psi and $\Delta p = 14.5$ psi

MO = Manual override

Technical information

The min. control pressure must be adhered to, since otherwise faulty switching and valve failure may result!

The pressure dew point must be at least 27 °F under ambient and medium temperature and may not exceed 5.4 °F .

The oil content of compressed air must remain constant during the life cycle.

Use only the approved oils from AVENTICS. Further information can be found in the "Technical information" document (available in the MediaCentre).

Technical information

Material

Housing	Die cast zinc, painted gray, Die-cast aluminum, painted gray
---------	--

Dimensions

Dimensions in inches

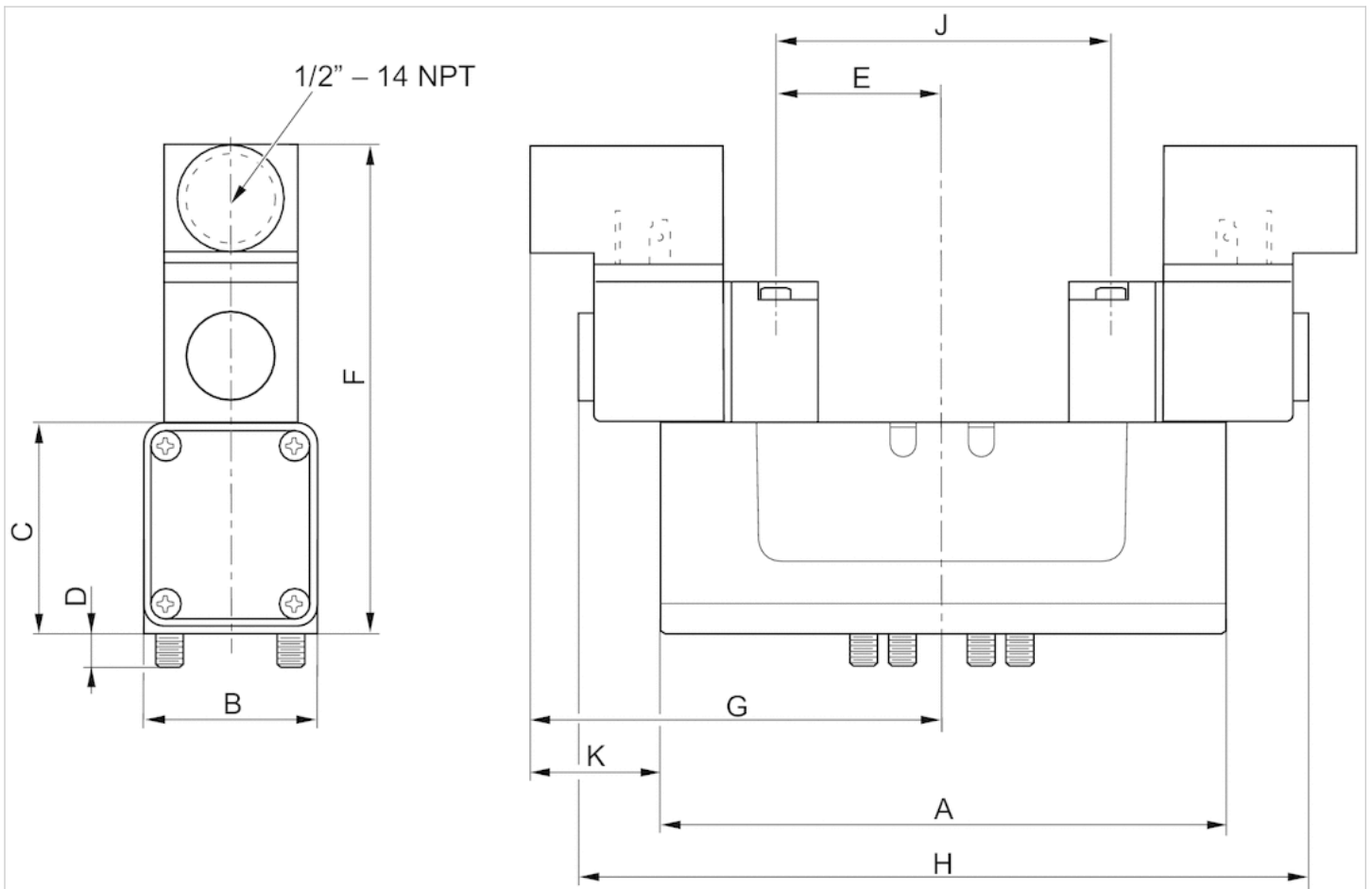

Dimensions in inches

Part No.	A	B	C	D	E	F	G	H	J	K
R432006292	8.62	3.09	2.89	0.41	1.62	5.32	6.65	13.31	3.25	0.68
R432006293	8.62	3.09	2.89	0.41	1.62	5.32	6.65	13.31	3.25	0.68
R432030338	8.62	3.09	2.89	0.41	1.62	5.32	6.65	13.31	3.25	0.68
R432006290	8.62	3.09	2.89	0.41	1.62	5.32	6.65	13.31	3.25	0.68
R432006291	8.62	3.09	2.89	0.41	1.62	5.32	6.65	13.31	3.25	0.68
-	-	-	-	-	-	-	-	-	-	-
R432002463	8.62	3.09	2.89	0.41	1.62	5.32	6.65	13.31	3.25	0.68



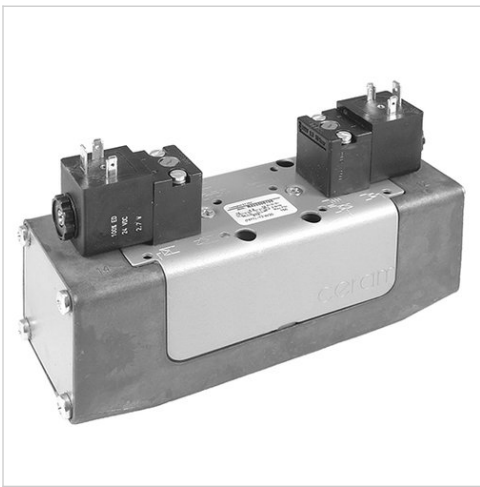

5/3-directional valve, Series CERAM™, size 4

- 5/3
- $Q_n = 7.62 \text{ Cv}$
- Pilot valve width : 30 mm CNOMO
- closed center
- Plate connection
- Electrical connection : Plug, EN 175301-803, form A
- Can be assembled into blocks
- Manual override : with detent, without detent
- Double solenoid, single solenoid
- Pilot : Internal, External



Activation	Electrically
Blocking principle	Single base plate principle
Standards	ISO 5599-1, ISO 4
Working pressure min./max.	0 ... 149 psi
Control pressure min./max.	See table below
Ambient temperature min./max.	5 ... 150 °F
Medium temperature min./max.	5 ... 150 °F
Medium	Compressed air
Nominal flow Q_n	7.62 Cv
Compressed air connection	according to ISO 5599-1
Protection class according to NEMA	NEMA 4
mounting screws	M8 with hexagon socket
Weight	5.42 lbs

Technical data

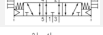
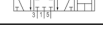
Part No.		MO	Compressed air connection	Operational voltage
			Pilot Exhaust	DC
R432029042		TT-R-TT-R-TT-R-TT-R-TT-R-TT-R	Base plate ISO 5599-1	12 V
R432006284	—		Base plate ISO 5599-1	24 V
R432030339			Base plate ISO 5599-1	-
R432006283			Base plate ISO 5599-1	-
R432030340			Base plate ISO 5599-1	-
R432002462			Base plate ISO 5599-1	-
R432002460			Base plate ISO 5599-1	-

Part No.	Operational voltage		Voltage tolerance
	AC 50 Hz	AC 60 Hz	DC
R432029042	-	-	-10% / +10%
R432006284	-	-	-10% / +10%
R432030339	24 V	24 V	-
R432006283	110 V	120 V	-
R432030340	220 V	240 V	-
R432002462	-	-	-
R432002460	-	-	-

Part No.	Voltage tolerance	Voltage tolerance	Power consumption	Holding power
	AC 50 Hz	AC 60 Hz	DC	AC 50 Hz
R432029042	-	-	2.7 W	-
R432006284	-	-	2.7 W	-
R432030339	-10% / +10%	-10% / +10%	-	3.7 VA
R432006283	-10% / +10%	-10% / +10%	-	3.7 VA
R432030340	-10% / +10%	-10% / +10%	-	3.7 VA
R432002462	-	-	-	-
R432002460	-	-	-	-

Part No.	Holding power	Switch-on power	Switch-on power	Pilot	Control pressure min./max.
	AC 60 Hz	AC 50 Hz	AC 60 Hz		
R432029042	-	-	-	Internal	37 ... 149 psi
R432006284	-	-	-	Internal	37 ... 149 psi
R432030339	3.7 VA	6.4 VA	6.4 VA	Internal	37 ... 149 psi
R432006283	3.7 VA	6.4 VA	6.4 VA	Internal	37 ... 149 psi
R432030340	3.7 VA	6.4 VA	6.4 VA	Internal	37 ... 149 psi
R432002462	-	-	-	Internal	37 ... 149 psi
R432002460	-	-	-	External	-11 ... 149 psi

Part No.	With valve plug connector	basic valve with electrical connector
R432029042	Without valve plug connector	-
R432006284	Without valve plug connector	-
R432030339	Without valve plug connector	-
R432006283	Without valve plug connector	-
R432030340	Without valve plug connector	-
R432002462	Without valve plug connector	Basic valve without coil
R432002460	Without valve plug connector	Basic valve without coil

Nominal flow Q_n at 87 psi and $\Delta p = 14.5$ psi

MO = Manual override

Technical information

The min. control pressure must be adhered to, since otherwise faulty switching and valve failure may result!

The pressure dew point must be at least 27 °F under ambient and medium temperature and may not exceed 5.4 °F .

The oil content of compressed air must remain constant during the life cycle.

Use only the approved oils from AVENTICS. Further information can be found in the "Technical information" document (available in the MediaCentre).

Technical information

Material

Housing	Die-cast aluminum, painted gray
---------	---------------------------------

Dimensions

Dimensions in inches

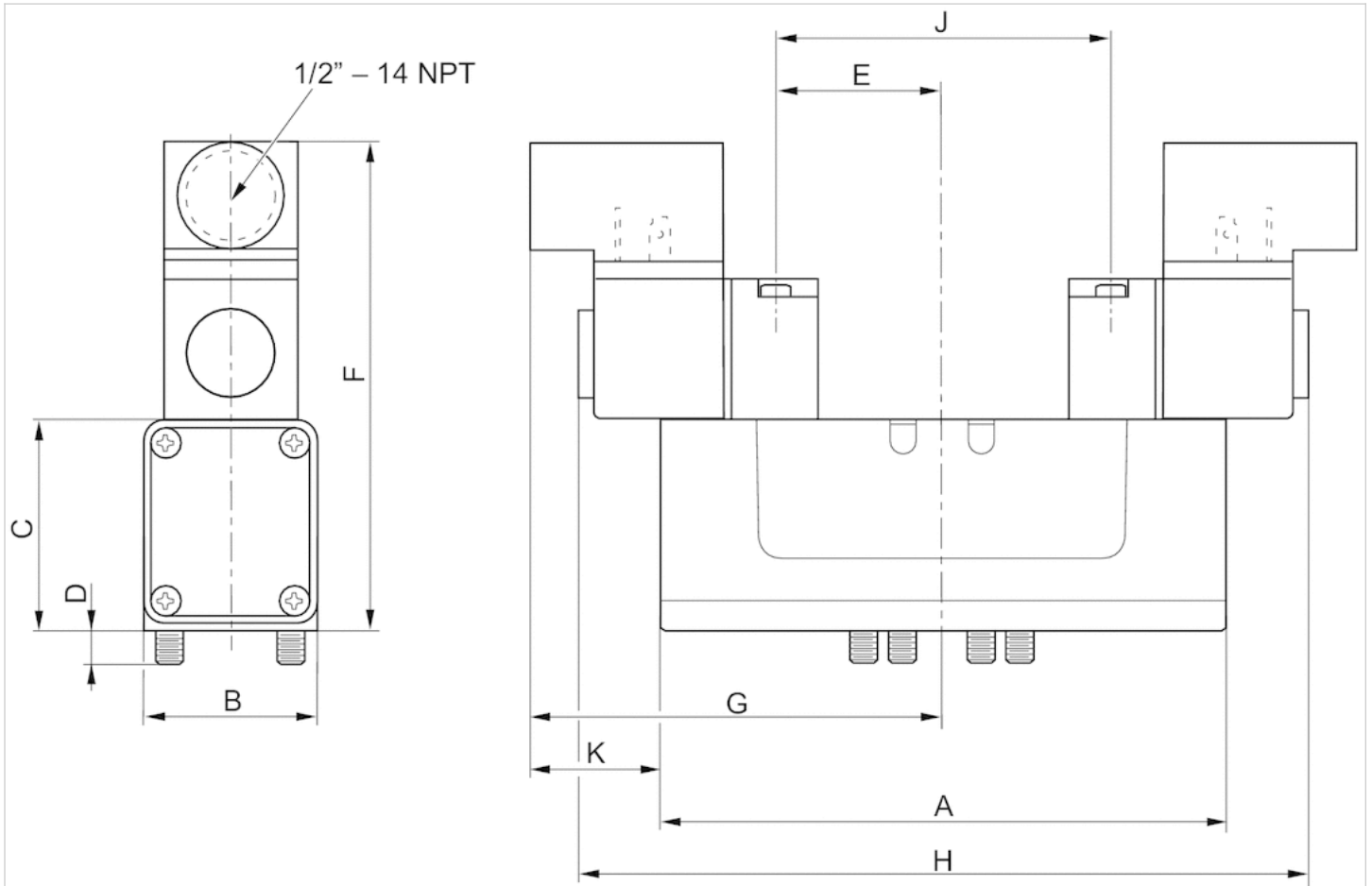

Dimensions in inches

Part No.	A	B	C	D	E	F	G	H	J	K
R432029042	8.62	3.09	2.89	0.41	1.62	5.32	6.65	13.31	3.25	0.68
R432006284	8.62	3.09	2.89	0.41	1.62	5.32	6.65	13.31	3.25	0.68
R432030339	8.62	3.09	2.89	0.41	1.62	5.32	6.65	13.31	3.25	0.68
R432006283	8.62	3.09	2.89	0.41	1.62	5.32	6.65	13.31	3.25	0.68
R432030340	8.62	3.09	2.89	0.41	1.62	5.32	6.65	13.31	3.25	0.68
R432002462	8.62	3.09	2.89	0.41	1.62	5.32	6.65	13.31	3.25	0.68
-	-	-	-	-	-	-	-	-	-	-

Valve plug connector, series CON-VP

- Socket, form A, 2+E, angled, 90°, Socket, form A, 3+E, angled, 90°

- EN 175301-803







- unshielded

- with LED Yellow, Red, Green, green/red



Connection type	Screws
Ambient temperature min./max.	-40 ... 194 °F
Operational voltage	See table below
Protection class	IP65
Mounting screw tightening torque	0.3, 0.15 ft./lbs.
Weight	See table below

Technical data

Part No.		Electrical connection	Operational voltage
		1	
1834484048		Socket, form A, 2+E, angled, 90°	300 V, DC
1834484059		Socket, form A, 3+E, angled, 90°	300 V, DC
1834484101		Socket, form A, 2+E, angled, 90°	24 V, AC/DC
1834484102		Socket, form A, 2+E, angled, 90°	110 V, AC
1834484103		Socket, form A, 2+E, angled, 90°	230 V, AC
8941016112		Socket, form A, 2+E, angled, 90°	230 V, AC
8941012462		Socket, form A, 3+E, angled, 90°	24 V, DC

Part No.	Max. current	Protective circuit	Contact assignment	LED status display	suitable cable-Ø min./max
1834484048	10 A	-	2+E	-	0.24 / 0.31 inch
1834484059	10 A	-	3+E	-	0.24 / 0.31 inch
1834484101	-	Z-diode	2+E	Yellow	0.24 / 0.31 inch
1834484102	-	Varistor	2+E	Red	0.24 / 0.31 inch
1834484103	-	Varistor	2+E	Red	0.24 / 0.31 inch
8941016112	-	Varistor	2+E	Green	0.31 / 0.39 inch
8941012462	8 A	-	3+E	green/red	0.18 / 0.43 inch

Part No.	Tightening torque for mounting screws [+0,05]	Seal	Weight	
1834484048	0.3 ft./lbs.	caoutchouc/butadiene caoutchouc	0.066 lbs	1)
1834484059	0.3 ft./lbs.	caoutchouc/butadiene caoutchouc	0.066 lbs	1)
1834484101	0.15 ft./lbs.	Silicone caoutchouc	0.066 lbs	2)
1834484102	0.15 ft./lbs.	caoutchouc/butadiene caoutchouc	0.066 lbs	1)
1834484103	0.15 ft./lbs.	Silicone caoutchouc	0.066 lbs	1)
8941016112	0.15 ft./lbs.	caoutchouc/butadiene caoutchouc	0.055 lbs	1)
8941012462	0.3 ft./lbs.	caoutchouc/butadiene caoutchouc	0.066 lbs	-

- 1) Profile seal
- 2) Flat gasket

Technical information

The specified protection class is only valid in assembled and tested state.

Technical information

Material

Seals

caoutchouc/butadiene caoutchouc, Silicone caoutchouc

Dimensions

Dimensions

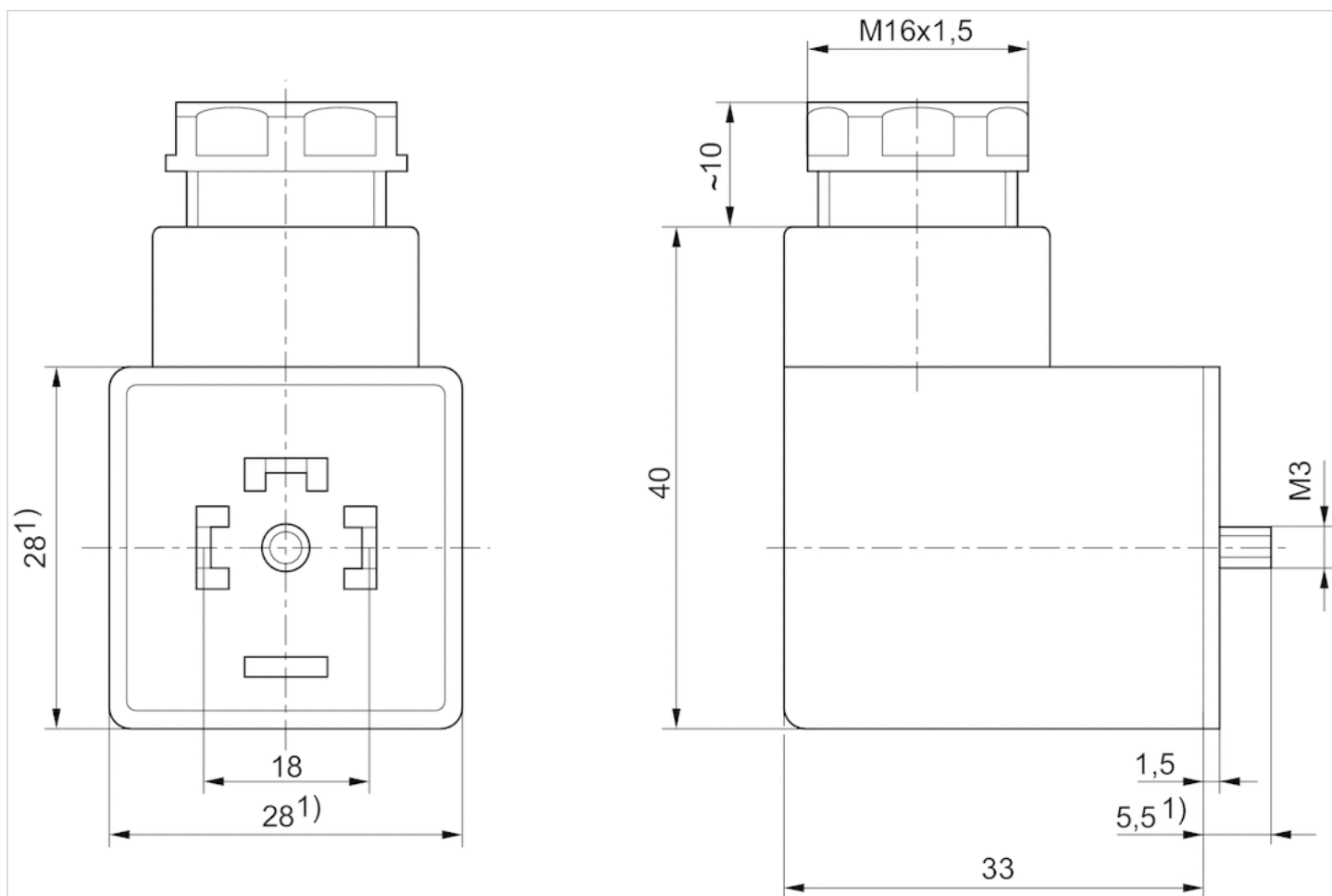

1) Max.

Valve plug connector, series CON-VP

- Socket, form A, 2+E, angled, 90°
- open cable ends, 3-pin
- with cable
- unshielded



Ambient temperature min./max.	-4 ... 176 °F
Operational voltage	See table below
Protection class	IP67
Wire cross-section	0.001 in ²
Mounting screw tightening torque	0.3 ft./lbs.
Weight	See table below

Technical data

Part No.		Operational voltage	Protective circuit	Contact assignment	LED status display
1834484160		230 V, AC/DC	-	2+E	-
1834484162		24 V, AC/DC	Z-diode	2+E	Yellow
1834484163		24 V, AC/DC	Z-diode	2+E	Yellow
1834484164		230 V, AC/DC	Varistor	2+E	Red
1834484165		230 V, AC/DC	Varistor	2+E	Red

Part No.	Number of wires	Cable length	Weight	Fig.	
1834484160	3	9.84 ft.	0.441 lbs	Fig. 1	1)
1834484162	3	9.84 ft.	0.441 lbs	Fig. 2	-
1834484163	3	16.4 ft.	0.683 lbs	Fig. 2	-
1834484164	3	9.84 ft.	0.441 lbs	Fig. 2	-
1834484165	3	16.4 ft.	0.683 lbs	Fig. 2	-

1) Scope of delivery incl. flat gasket

Technical information

The specified protection class is only valid in assembled and tested state.

Technical information

Material	
Seals	caoutchouc/butadiene caoutchouc
Cable sheath	Polyvinyl chloride

Dimensions

Fig. 1

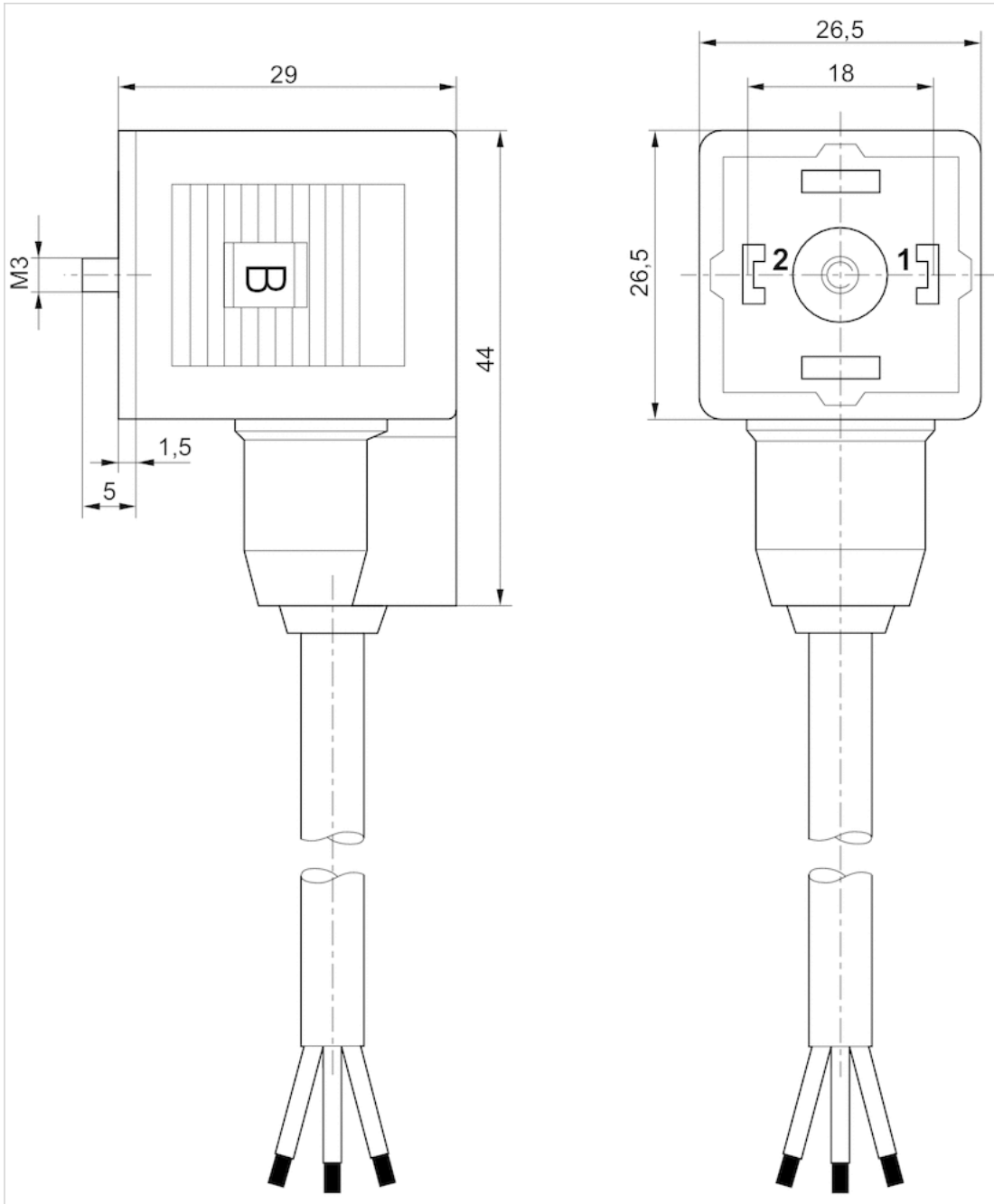

Fig. 2

